

© 2007 Mazda Motor of America, Inc.

| | |
|---|--------------------------------|
| Subject: POWER RETRACTABLE HARDTOP - DIFFICULT TO OPEN / CRUNCH NOISE WHEN OPENING | Bulletin No: 09-038/07 |
| | Last Issued: 11/15/2007 |

APPLICABLE MODEL(S)/VINS

2007 MX-5 vehicles equipped with Power Retractable Hardtop and VINs lower than JM1 NC**** ** 142750 (built before September 1, 2007)

DESCRIPTION

Some vehicles may experience that when trying to open (lower) the Power Retractable Hardtop (RHT), the RHT exhibits a crunching noise and has difficulty opening from the fully closed (up) position.

The clearance between the male wedge (A) on the vehicle body and the receiver on the deck (B) is too tight. As a mass-production change, the shape of the male wedge (A) has been changed. Customers having this concern should have their vehicle repaired using the following repair procedure. The male wedge (A) and both left and right cam plates (C) will need to be replaced.

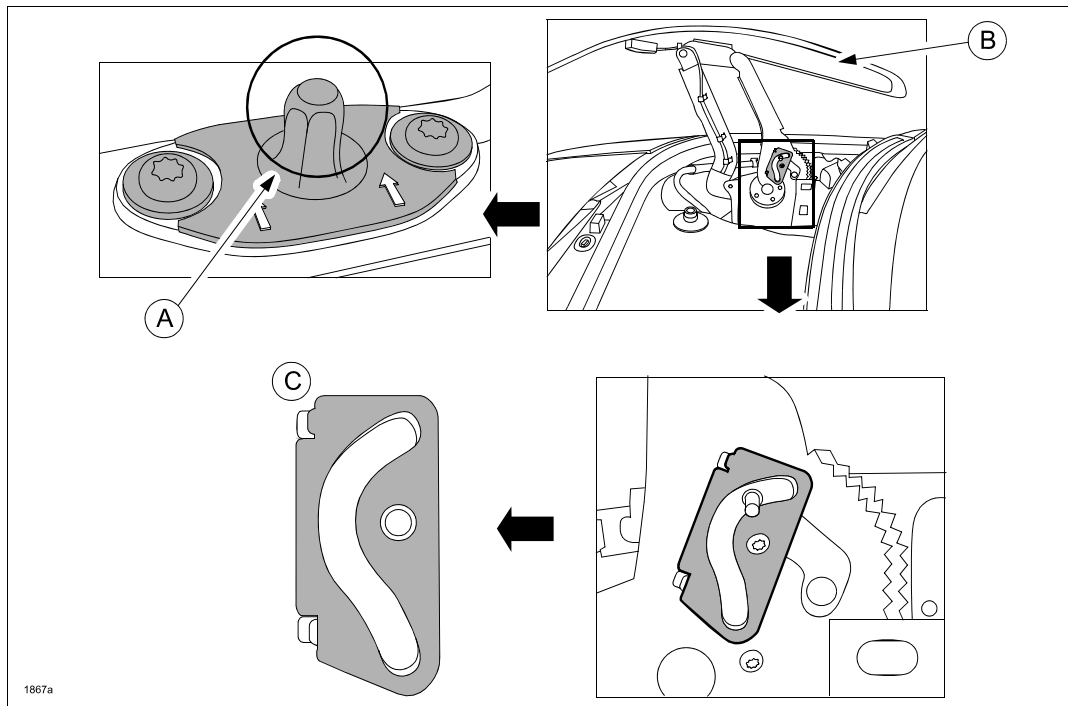

CONSUMER NOTICE: The information and instructions in this bulletin are intended for use by skilled technicians. Mazda technicians utilize the proper tools/equipment and take training to correctly and safely maintain Mazda vehicles. These instructions should not be performed by "do-it-yourselfers." Customers should not assume this bulletin applies to their vehicle or that their vehicle will develop the described concern. To determine if the information applies, customers should contact their nearest authorized Mazda dealership. Mazda North American Operations reserves the right to alter the specifications and contents of this bulletin without obligation or advance notice. All rights reserved. No part of this bulletin may be reproduced in any form or by any means, electronic or mechanical---including photocopying and recording and the use of any kind of information storage and retrieval system ---without permission in writing.

REPAIR PROCEDURE

1. Verify customer concern.
2. Place rear deck in full open position.

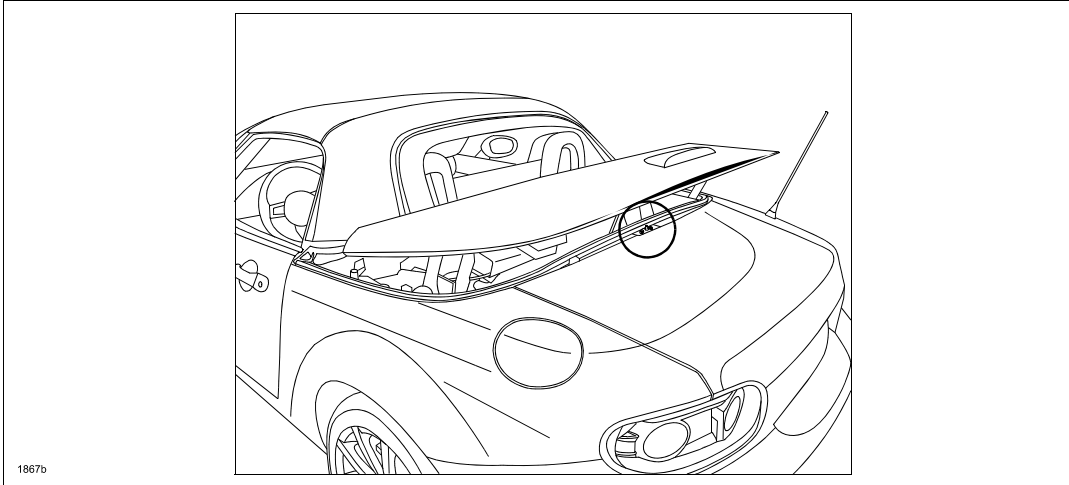

3. Replace the existing male wedge with a modified one. Apply LOCTITE® to screws.
Torque: 35-53 in.lbf (4-6 N.m)

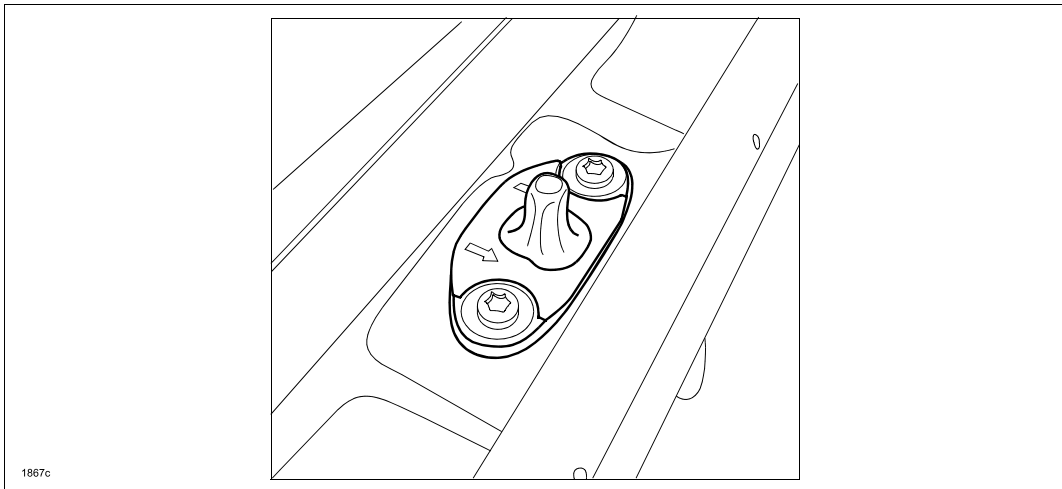

4. Replace left and right cam plates one side at a time with modified ones.
 - a. Remove the rear most push clip and pull back the side shelf to access the cam plate.
 - b. Remove screw attaching cam plate to hinge.
 - c. Rotate cam plate outward from screw end to disengage retainers.
 - d. Insert new cam plate retainers into hinge. Install screw using LOCTITE®.
Torque: 26-32 in.lbf (3.0-3.7 N.m)
 - e. Apply Krytox grease (sourced locally) to the roller guide in the cam plates.

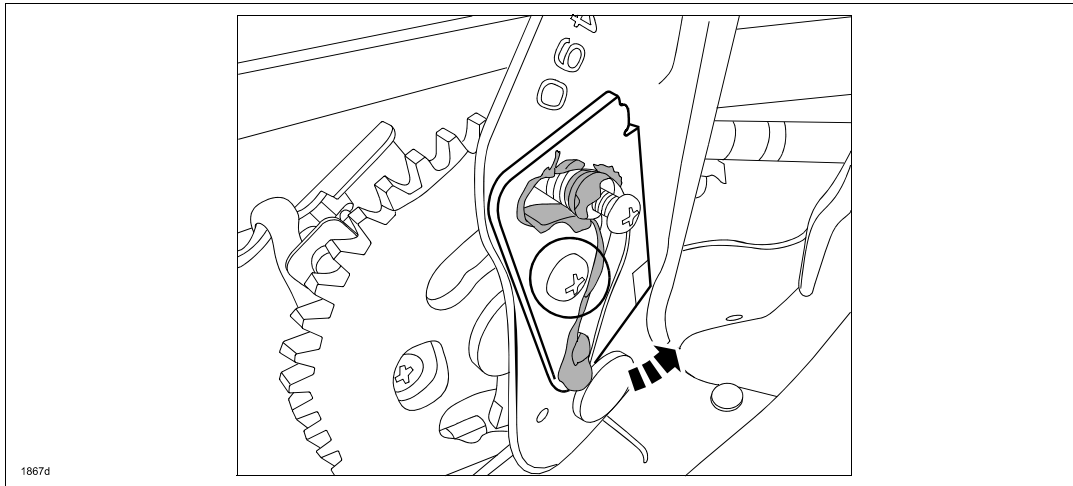

5. Verify repair.

PART(S) INFORMATION

| Part Number | Description | Qty. | Notes |
|--------------|---------------|------|-------|
| NE52-R1-9B1B | Male Wedge | 1 | --- |
| NG20-R1-6CX | Cam Plate (R) | 1 | --- |
| NG20-R1-6CY | Cam Plate (L) | 1 | --- |

WARRANTY INFORMATION

NOTE:

- This warranty information applies only to verified customer complaints on vehicles eligible for warranty repair. Refer to the Warranty Wizard for warranty term information.
- Additional diagnostic time cannot be claimed for this repair.

| | |
|---------------------------------|--------------------|
| Warranty Type | A |
| Symptom Code | 90 |
| Damage Code | 97 |
| Part Number Main Cause | NE52-R1-9B1B |
| Quantity | 1 |
| Operation Number / Labor Hours: | XXC4FXRX / 0.2 Hrs |